



# THE Villager

www.bv.org

A Quarterly Publication Of Brethren Village

Two days to visit Brethren Village! October 26th & 27th

For directions to our campus and more information, call us or visit [www.bv.org/OpenHouse](http://www.bv.org/OpenHouse)

## Open House

- + More financial options
- + More living choices

Adds up to more to explore.

### Join us!

Friday, October 26 from 3–6 pm or Saturday, October 27 from 10 am–2 pm for our Fall Open House

Brethren Village invites you to visit our campus during the Second Annual CCRC Explore Retirement Living Open House. You'll be able to explore our residential and personal care options at your leisure, plus enjoy refreshments, tour new amenities and more. No reservations are needed. We hope to see you here!



- Residential living cottage and apartment tours
- Personal care and memory support apartments, services and building tours
- Woodshop, fitness center and other activities open
- Refreshments
- Shuttle service available

*(Enter campus from Lititz Pike at Fieldcrest Drive and follow Open House signs)*

## Calendar of Events

- Oct. 3** BV Pastoral Services presents "Amen Choir," Wolfe Auditorium at 1:30 PM
- Oct. 4** Elite Coaches and Brethren Village are offering a trip to the Franklin Institute in Philadelphia to see the presentation of the Dead Sea Scrolls. Lunch at City Tavern Restaurant in the historic area, free time in historic area. Call Pat Griggs, 581-4470, for a flyer and information.
- Oct. 6** Fall Love Feast hosted by East Cocalico COB, Wolfe Auditorium, 6:00 PM
- Oct. 17** "Heart to Heart Choir," a 45 member acapella choir of conservative Mennonite youth, Wolfe Auditorium, 7:00 PM
- Oct. 18** "BV's Got Talent," showcasing the many assorted talents of BV residents, Wolfe Auditorium, 2:00 PM
- Oct. 23** Presentation by Mahlon Fuller, retired Air Traffic Controller from Pittsburgh airport — one of the last persons to converse with members of Flight 93 on Sept. 11, 2001, before it went down in Shanksville, PA. Freewill offering for the Shanksville Flight 93 monument and grounds. Wolfe Auditorium, 2:00 PM
- Thursday, Oct. 25 and Friday, Oct. 26** Elite Coaches and Brethren Village present an overnight Fall bus trip to Mercer County, PA, where we will spend the night at "Tara" Bed & Breakfast — a restored 1854 Antebellum mansion and museum of Gone With the Wind memorabilia. The next day we will tour the National Monument to Flight 93 at Shanksville. This tour includes the Avenue of Flags, and smorgasbord at Oakhurst Tea Room, a full family style meal and breakfast buffet at "Tara," plus other misc. items. Call Pat Griggs, 581-4470, for details and a flyer.
- Oct. 28** Service of Remembrance, Chapel, 3:00 PM
- Nov. 21** Thanksgiving Eve Service, Chapel, 2:00 PM
- Nov. 28** Advent Communion, Chapel, 2:00 PM
- Dec. 11** BV Choir Christmas program, Fieldcrest Great Room, 7:00 PM
- Dec. 12** BV Choir Christmas program, Wolfe Auditorium, 7:00 PM
- Dec. 24** Christmas Eve service, Chapel, 2:00 PM
- Jan. 17** Annual Education Seminar, Wolfe Auditorium, 7:30 AM

Please note... All listed events are open to the public!

### Inside This Issue



Goal reached for new pool project



Past BV Board Chair receives honorary degree



Residents gather for Summer Soiree



3001 Lititz Pike, P.O. Box 5093  
Lancaster, PA 17606-5093



## BV's The Courtyards Receive a 4-Star Medicare Rating

### About Medicare Star Ratings

The Five Star Quality Rating System was created to help consumers, their families, and caregivers compare skilled care centers more easily and help identify areas about which you may want to ask questions. This rating system is based on continued efforts as a result of the Omnibus Reconciliation Act of 1987 (OBRA '87), a nursing home reform law, and more recent quality improvement campaigns such as the Advancing Excellence in America's Nursing Homes, a coalition of consumers, health care providers, and nursing home professionals.

Skilled care center ratings are taken from the following 3 sources of data:

- Health Inspections
- Staffing
- Quality Measures

CMS provides a Medicare star rating for each of these three sources, in case some areas are more important to you than others. Then, these three ratings are combined to calculate an overall rating.

### Why is this important?

Skilled care centers vary in the quality of care and services they provide to their residents. Reviewing health inspection results, staffing data, and quality measure data are three important ways to measure skilled care quality. This information gives you a "snap shot" of the health care provided. One of the most important things you can do is visit the nursing homes you are considering.



## Announcing the SHELLY AQUATIC CENTER, a new wellness pool, made possible by the Naomi Shelly estate and other contributors.

Due to the generous contributions of board members, Residents and friends, we are proud to announce that we have reached our goal of raising \$160,000 for the new pool project. The grand opening of our new pool and unveiling of the donor recognition plaque is slated for fall 2012.

"We greatly appreciate how our community has come together and generously donated to this campaign. The new pool features a 60 ft x 30 ft wellness pool, whirlpool tub with dedicated access and entry, and zero entry ramp to the pool for those with restricted movement. Construction is expected to be completed soon, and we are planning to celebrate with a grand opening later in the fall. We look forward to the opportunity for expanded programming to our residents, team members and the community," said Michele Stipe, Wellness Manager.

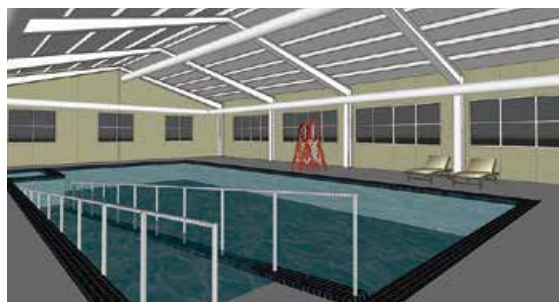

Naomi Shelly became a resident of Brethren Village in 1988. She lived at the Village for 18 years and loved using the pool. When Naomi passed away, she remembered Brethren Village in her estate plan and left a generous bequest that was used to kick off the pool project.

### You, Too, Can Leave a Legacy...

One of the most satisfying things you will be able to do by taking time to plan your estate is to make decisions that benefit charities which you have supported during your lifetime. In fact, many of the most substantial gifts that Brethren Village receives come as bequests from contributors who, after taking care of family members, decide to share a portion of their assets with us.

You, too, can have a significant impact on our ministry by choosing to leave a percentage or residual of your estate to Brethren Village. Specific sums and other property are also welcome. Brethren Village has a long history of serving the community and your thoughtful choice to include us in your estate plans will go a long way to continue our ministry into the future.

For additional information, please contact the Brethren Village Development Dept. at 717-581-4316 or email: Joannes@bv.org.



Residents bring home gold, silver, and bronze medals at the Lancaster Senior Games, held at Franklin & Marshall College earlier this summer. Residents pictured (Front row; L-R:) Carol Shank, Sally Bingaman, LaRue Helm, Carl Risser, Tom Figart, Curt Good. (Back Row; L-R:) Bill Evans, Sigfrid Hellstrom, Al Mannon, James Shank, Barry Nymann. Not pictured: Shirley Brady, Pat Johnston, Bill Culp.

## Henry H. Gibbel, Past BV Board Chair and CEO of Lititz Mutual Insurance Co., Receives Honorary Degree at 2012 Juniata College Commencement

Henry H. Gibbel, Chairman and Chief Executive Officer of Lititz Mutual Insurance Co. and a former Chair of the Juniata College board of trustees, received an honorary Doctor of Humane Letters degree from Juniata College, Saturday, May 12 during Juniata's 134th commencement ceremony.

Gibbel is a 1957 Juniata graduate and served as Chair of the Juniata Board of Trustees from 2001 to 2006 and received the John C. Baker Award for Exemplary Service from the Board in 2006. Gibbel has served as a trustee since 1973. He also was President of the college's National Alumni Association. In 1992, he received the Juniata College Alumni Service Award. In 2005, he received Juniata's Church College Service Award.

Gibbel and his wife, Joan, in 2002 sponsored the Henry and Joan Gibbel Award for Distinguished Teaching, which recognizes excellence in teaching among faculty members who have been at Juniata College for fewer than six years. He also played a significant role in Juniata's most successful capital campaign, the Uncommon Outcomes Campaign, serving as co-chair of the Campaign for the Future. The Lititz resident was inducted into the Juniata College Sports Hall of Fame in 2000. He also was Chair of the college's past two Presidential search committees in 1985 and again in 1997.

Gibbel is past Chairman and Director Emeritus of Brethren Village.

The Gibbels have two daughters, a son, and eight grandchildren. His son, Henry R. Gibbel, graduated from Juniata in 1981.



Yes...  
I want to explore  
the possibilities!

- Please send a residential marketing packet to the address listed below.
- Please contact me to schedule an appointment with a representative today.
- Please contact me to schedule a campus tour with a representative today.

Name: \_\_\_\_\_

Address: \_\_\_\_\_

City: \_\_\_\_\_

State & Zip: \_\_\_\_\_

Phone: \_\_\_\_\_

Email: \_\_\_\_\_

**Please remit to:** Brethren Village, Residential Marketing Department, PO Box 5093, Lancaster, PA 17606-5093. In accordance with our Privacy Policy, by providing your name and telephone number above you grant permission for a representative of Brethren Village to communicate with you. Your personal information is confidential and will not be sold or released to other parties.

**Questions?** Please contact Scott Wissler, Director of Marketing, at (717) 581-4227 or e-mail [info@bv.org](mailto:info@bv.org)

## Welcome to New Residents

### May 2012

**Elizabeth Detwiler** Village Garden Apartments, formerly of Millersville

**Yvonne Ehrhart** Cottage, formerly of Lancaster

**Erla Gilder** Village Garden Apartments, formerly of Landisville

**Dudley & Deanna Myers** Fieldcrest, formerly of East Petersburg

**Harold & Peggy Rupp** Cottage, formerly of Ephrata

**Elizabeth Seedes** Fairview Meadows, formerly of Lititz

**William & Pauline Smith** Fieldcrest, formerly of Erwin, TN

### June 2012

**Florence Allhouse** Fieldcrest, formerly of Manheim

**Catherine Binasiwicz** Village Townhouse, formerly of Warminster, PA

**Robert & Diane Haehnle** Fieldcrest, formerly of Brunnerville

**Lawrence & June Hodges** Fieldcrest, formerly of Bryan, OH

**William Lawlar** Fairview Meadows, formerly of Lititz

**Harley Nygren** Fieldcrest, formerly of Washington, DC

**Lawrence Pennell** Village Townhouse, formerly of Blue Bell, PA

**Ethyl Reidenbaugh** Village Townhouse, formerly of Lancaster

**Shirley Stoltzfus** Village Townhouse, formerly of Harrisonburg, VA

### July 2012

**Alla Berezinskaia** Village Garden Apartments, formerly of Lititz

**Margaret Bomberger** Fieldcrest, formerly of Palmyra

**Mary Harvey** Fieldcrest, formerly of Mt. Joy

**Steven & Naomi Johnson** Fieldcrest, formerly of Ephrata

**Andrew & Paula Krause** Fieldcrest, formerly of Vero Beach, FL

### August 2012

**Nicholas & Helen Carthage** Fieldcrest, formerly of Bethlehem, PA

**J. Becker & Vera Ginder** Village Townhouse, formerly of Manheim

**Harold & Anna Marie Groff** Fieldcrest, formerly of Strasburg

**Ronald & Linda Horton** Village Townhouse, formerly of Manheim

**Joel & Carol Kaltreider** Fieldcrest, formerly of Elizabethtown

**Clem & Margaret Rosenberger** Cottage, formerly of Lancaster

**Mabel Umble** Fieldcrest, formerly of Lancaster

**Marvin & Regina Zimmerman** Fieldcrest, formerly of Bernville

**BV** BrethrenVillage

# Fall 2012

Official Publication of Brethren Village  
Retirement Community



3001 Lititz Pike, P.O. Box 5093  
Lancaster, PA 17606-5093  
Telephone: 717-581-4227 or  
800-367-9899

[www.bv.org](http://www.bv.org)

[www.twitter.com/BrethrenVillage](https://www.twitter.com/BrethrenVillage)

[www.facebook.com/BrethrenVillage](https://www.facebook.com/BrethrenVillage)



### Our Vision

Enriching each life touched by our ministry at Brethren Village.

### Our Mission

Rooted in the tradition of service within the Church of the Brethren, the mission of Brethren Village is to provide a continuum of services and Christ-like care to support the aging process and to enhance the spiritual, physical, social and emotional wholeness of Residents, Team Members, and community.

### Board of Directors

#### Chairman

F. Barry Shaw

#### Vice Chairman

Carol D. Hess

#### Treasurer

Steven L. Faus

#### Secretary

David L. Hawthorne

#### Assistant Secretary / Treasurer

Steven L. Edris

#### Directors

Evelyn Dehmey

Douglas F. Deihm

Kathy M. Long

Alan R. Over

Wilbur G. Rohrer

Larry D. Sauder

John N. Snader

#### Director Emeritus

Henry H. Gibbel

#### Director Emerita

S. Joan Hershey

Carroll L. Kreider

#### Resident Representative

Linda J. Heck

#### Auxiliary President

Elizabeth Martin

#### Resident Council President

Leon E. Whiteman

#### President

Gary N. Clouser, NHA

#### Vice President Finance

Pamela S. Formica, CPA

#### Vice President Support Services

Philip S. Hollinger

#### Editor

Tara Marie Ober  
Public Relations Manager

*Brethren Village is an  
Equal Opportunity Employer*



### Opt-Out Policy

If you wish your name removed from the mailing list to receive future newsletters or fundraising materials supporting Brethren Village, please send a written request to: Director of Development, 3001 Lititz Pike, P.O. Box 5093, Lancaster, PA 17606-5093.

The official registration and financial information of Brethren Village may be obtained from the Pennsylvania Department of State by calling toll free, within Pennsylvania, 1-800-732-0999. Registration does not imply endorsement.

# Q&A

If you're considering moving to a CCRC, here are some questions you should ask:

### Q: How does living in a Continuing Care Retirement Community (CCRC) differ from living in my own home?

A: Living at Brethren Village is just like living in your own home. You come and go as you please, plus have the conveniences of on-campus services and amenities such as a pharmacy, bank, and pool right in your own backyard. Should you ever need advanced care, our on-campus personal care, memory support, skilled care, home care and therapy services are here if you need them. What is better than living in a safe, secure, and warm community environment?

### Q: How do I go about deciding which retirement community is right for me?

A: There are several pieces of information you should ask for when visiting a community. Comparing the marketing materials, residential service plans, financial plans, disclosure statements, resident contracts and resident handbooks of each community should give you enough information to make an informed decision. If you have a question about our community, just ask!

### Q: Do Residents have a voice in how Brethren Village is run?

A: Yes. Residents have several ways to voice their opinion and make suggestions regarding the policies and procedures practiced by the Village. Our Residents' Councils meet monthly and give Resident Representatives the opportunity to share their thoughts and communicate with the management and Team Members of the Village. Quarterly Town Meetings are also held where financial, operational and strategic planning updates and opportunities are shared with all Residents.

### Q: Are there financial guidelines for entering Brethren Village?

A: Brethren Village is a community dedicated to providing care for the duration of our Resident's lives.

Because of our commitment to this philosophy, there are financial covenants that are mutually agreed upon by the Resident and the Village before a Resident is admitted. Since there are many different financial factors considered when admitting a Resident, it is best to discuss your particular circumstance with one of our sales counselors.

### Q: What are the fees involved in moving to Brethren Village and what do they cover?

A: Brethren Village offers various Residential Service Plans from Traditional to Life Care Plans. When moving into residential living, you pay a one-time entrance fee and a monthly service fee, that together, cover a lifetime lease on the residence of your choice plus living expenses such as utilities, home maintenance, security, and use of the Village's programs and facilities. The entrance fee, monthly service fee, and optional extended service fee varies by the size and style of the home you choose. As you advance through continuing care, your Residential Service Plan outlines the Life Care Credit Benefits or per-diem rates designated for advanced care.

### Q: How do I get on Brethren Village's waitlist and how long do I have to wait to be offered a home?

A: The first step is to submit an application. The application will tell us what style and size of residence you are interested in and when you are thinking of making a move. We will invite you to campus for a personal consultation and informational tour. We will then contact you when an appropriate accommodation becomes available based on your standing within our waitlist. Accommodations are offered to people on our waitlist with the earliest application dates who are ready to move. The length of time between submitting an application and being offered a home varies by the accommodation.

**More choices. Your choices.**



## Summer Soiree

On June 14, over 500 Residents and guests of the Village gathered behind the Fieldcrest building for a Summer Soiree. The evening couldn't have been nicer as everyone enjoyed the sounds of the New Holland Swing Band, the beautiful weather, and a delicious meal provided by Hess's Barbecue & Catering.